



Doncaster
Application for a premises licence
Licensing Act 2003

For help contact

Telephone: 01302 737590

* required information

Section 1 of 21

You can save the form at any time and resume it later. You do not need to be logged in when you resume.

System reference

Not Currently In Use

This is the unique reference for this application generated by the system.

Your reference

You can put what you want here to help you track applications if you make lots of them. It is passed to the authority.

Are you an agent acting on behalf of the applicant?

- Yes No

Put "no" if you are applying on your own behalf or on behalf of a business you own or work for.

Applicant Details

* First name

THAMBIAYA

* Family name

THANABALAN

* E-mail

Main telephone number

Include country code.

Other telephone number

- Indicate here if the applicant would prefer not to be contacted by telephone

Is the applicant:

- Applying as a business or organisation, including as a sole trader
 Applying as an individual

A sole trader is a business owned by one person without any special legal structure. Applying as an individual means the applicant is applying so the applicant can be employed, or for some other personal reason, such as following a hobby.

Continued from previous page...

Address

* Building number or name	<input type="text"/>
* Street	<input type="text"/>
District	<input type="text"/>
* City or town	<input type="text"/>
County or administrative area	<input type="text"/>
* Postcode	<input type="text"/>
* Country	<input type="text"/>

Agent Details

* First name	<input type="text" value="IAN"/>
* Family name	<input type="text" value="RUSHTON"/>
* E-mail	<input type="text"/>
Main telephone number	<input type="text"/>
Other telephone number	<input type="text"/>

Include country code.

Indicate here if you would prefer not to be contacted by telephone

Are you:

- An agent that is a business or organisation, including a sole trader
 A private individual acting as an agent

A sole trader is a business owned by one person without any special legal structure.

Agent Business

Is your business registered in the UK with Companies House? Yes No

Note: completing the Applicant Business section is optional in this form.

Is your business registered outside the UK? Yes No

Business name	<input type="text" value="JL LICENCE AND RETAIL"/>
VAT number	<input type="text" value="-"/> <input type="text" value="NONE"/>
Legal status	<input type="text" value="Sole Trader"/>
Your position in the business	<input type="text" value="OWNER"/>
Home country	<input type="text" value="United Kingdom"/>

If your business is registered, use its registered name.

Put "none" if you are not registered for VAT.

The country where the headquarters of your business is located.

Continued from previous page...

Agent Business Address

If you have one, this should be your official address - that is an address required of you by law for receiving communications.

Building number or name	<input type="text"/>
Street	<input type="text"/>
District	<input type="text"/>
City or town	<input type="text"/>
County or administrative area	<input type="text"/>
Postcode	<input type="text"/>
Country	<input type="text"/>

Section 2 of 21

PREMISES DETAILS

I/we, as named in section 1, apply for a premises licence under section 17 of the Licensing Act 2003 for the premises described in section 2 below (the premises) and I/we are making this application to you as the relevant licensing authority in accordance with section 12 of the Licensing Act 2003.

Premises Address

Are you able to provide a postal address, OS map reference or description of the premises?

- Address OS map reference Description

Postal Address Of Premises

Building number or name	<input type="text" value="THE LOCAL"/>
Street	<input type="text" value="132 SPOTBROUGH ROAD"/>
District	<input type="text"/>
City or town	<input type="text" value="DONCASTER"/>
County or administrative area	<input type="text"/>
Postcode	<input type="text" value="DN5 8BA"/>
Country	<input type="text" value="United Kingdom"/>

Further Details

Telephone number	<input type="text"/>
Non-domestic rateable value of premises (£)	<input type="text" value="0"/>

Section 3 of 21

APPLICATION DETAILS

In what capacity are you applying for the premises licence?

- An individual or individuals
- A limited company / limited liability partnership
- A partnership (other than limited liability)
- An unincorporated association
- Other (for example a statutory corporation)
- A recognised club
- A charity
- The proprietor of an educational establishment
- A health service body
- A person who is registered under part 2 of the Care Standards Act 2000 (c14) in respect of an independent hospital in Wales
- A person who is registered under Chapter 2 of Part 1 of the Health and Social Care Act 2008 in respect of the carrying on of a regulated activity (within the meaning of that Part) in an independent hospital in England
- The chief officer of police of a police force in England and Wales

Confirm The Following

- I am carrying on or proposing to carry on a business which involves the use of the premises for licensable activities
- I am making the application pursuant to a statutory function
- I am making the application pursuant to a function discharged by virtue of Her Majesty's prerogative

Section 4 of 21

INDIVIDUAL APPLICANT DETAILS

Applicant Name

Is the name the same as (or similar to) the details given in section one?

- Yes No

If "Yes" is selected you can re-use the details from section one, or amend them as required. Select "No" to enter a completely new set of details.

First name

Family name

Is the applicant 18 years of age or older?

- Yes No

Continued from previous page...

Current Residential Address

Is the address the same as (or similar to) the address given in section one?

If "Yes" is selected you can re-use the details from section one, or amend them as required. Select "No" to enter a completely new set of details.

Yes No

Building number or name	<input type="text"/>
Street	<input type="text"/>
District	<input type="text"/>
City or town	<input type="text"/>
County or administrative area	<input type="text"/>
Postcode	<input type="text"/>
Country	<input type="text"/>

Applicant Contact Details

Are the contact details the same as (or similar to) those given in section one?

If "Yes" is selected you can re-use the details from section one, or amend them as required. Select "No" to enter a completely new set of details.

Yes No

E-mail	<input type="text"/>
Telephone number	<input type="text"/>
Other telephone number	<input type="text"/>
* Date of birth	<input type="text"/> / <input type="text"/> / <input type="text"/> dd mm yyyy
* Nationality	<input type="text"/>
Right to work share code	<input type="text"/>

Documents that demonstrate entitlement to work in the UK
Right to work share code if not submitting scanned documents

Section 5 of 21

OPERATING SCHEDULE

When do you want the premises licence to start? 14 / 04 / 2023
dd mm yyyy

If you wish the licence to be valid only for a limited period, when do you want it to end / /
dd mm yyyy

Provide a general description of the premises

Continued from previous page...

For example the type of premises, its general situation and layout and any other information which could be relevant to the licensing objectives. Where your application includes off-supplies of alcohol and you intend to provide a place for consumption of these off- supplies you must include a description of where the place will be and its proximity to the premises.

This is a new business venture and the site, currently empty, is to be refurbished to become a new general convenience store serving the local community selling a wide range of goods including newspapers, magazines, bread, milk, soft drinks, cigarettes, confectionery, household goods, snacks, etc.

The applicant would like to offer some alcohol for sale alongside the other goods. Late night refreshment (hot drinks) is also proposed.

The proposed alcohol sales would just be a part of the overall business to offer the complete all-round convenience service to customers.

If 5,000 or more people are expected to attend the premises at any one time, state the number expected to attend

Section 6 of 21

PROVISION OF PLAYS

[See guidance on regulated entertainment](#)

Will you be providing plays?

- Yes No

Section 7 of 21

PROVISION OF FILMS

[See guidance on regulated entertainment](#)

Will you be providing films?

- Yes No

Section 8 of 21

PROVISION OF INDOOR SPORTING EVENTS

[See guidance on regulated entertainment](#)

Will you be providing indoor sporting events?

- Yes No

Section 9 of 21

PROVISION OF BOXING OR WRESTLING ENTERTAINMENTS

[See guidance on regulated entertainment](#)

Will you be providing boxing or wrestling entertainments?

- Yes No

Section 10 of 21

PROVISION OF LIVE MUSIC

[See guidance on regulated entertainment](#)

Continued from previous page...

Will you be providing live music?

Yes No

Section 11 of 21

PROVISION OF RECORDED MUSIC

[See guidance on regulated entertainment](#)

Will you be providing recorded music?

Yes No

Section 12 of 21

PROVISION OF PERFORMANCES OF DANCE

[See guidance on regulated entertainment](#)

Will you be providing performances of dance?

Yes No

Section 13 of 21

PROVISION OF ANYTHING OF A SIMILAR DESCRIPTION TO LIVE MUSIC, RECORDED MUSIC OR PERFORMANCES OF DANCE

[See guidance on regulated entertainment](#)

Will you be providing anything similar to live music, recorded music or performances of dance?

Yes No

Section 14 of 21

LATE NIGHT REFRESHMENT

Will you be providing late night refreshment?

Yes No

Standard Days And Timings

MONDAY

Start

End

Start

End

TUESDAY

Start

End

Start

End

WEDNESDAY

Start

End

Start

End

THURSDAY

Start

End

Start

End

Give timings in 24 hour clock. (e.g., 16:00) and only give details for the days of the week when you intend the premises to be used for the activity.

Continued from previous page...

FRIDAY

Start End

Start End

SATURDAY

Start End

Start End

SUNDAY

Start End

Start End

Will the provision of late night refreshment take place indoors or outdoors or both?

- Indoors Outdoors Both

Where taking place in a building or other structure tick as appropriate. Indoors may include a tent.

State type of activity to be authorised, if not already stated, and give relevant further details, for example (but not exclusively) whether or not music will be amplified or unamplified.

PROVISION OF A HOT DRINKS VIA A COFFEE MACHINE

State any seasonal variations

For example (but not exclusively) where the activity will occur on additional days during the summer months.

Non-standard timings. Where the premises will be used for the supply of late night refreshments at different times from those listed in the column on the left, list below

For example (but not exclusively), where you wish the activity to go on longer on a particular day e.g. Christmas Eve.

Section 15 of 21

SUPPLY OF ALCOHOL

Will you be selling or supplying alcohol?

- Yes No

Continued from previous page...

Standard Days And Timings

MONDAY

Start

End

Start

End

Give timings in 24 hour clock.
(e.g., 16:00) and only give details for the days
of the week when you intend the premises
to be used for the activity.

TUESDAY

Start

End

Start

End

WEDNESDAY

Start

End

Start

End

THURSDAY

Start

End

Start

End

FRIDAY

Start

End

Start

End

SATURDAY

Start

End

Start

End

SUNDAY

Start

End

Start

End

Will the sale of alcohol be for consumption:

- On the premises Off the premises Both

If the sale of alcohol is for consumption on
the premises select on, if the sale of alcohol
is for consumption away from the premises
select off. If the sale of alcohol is for
consumption on the premises and away
from the premises select both.

State any seasonal variations

For example (but not exclusively) where the activity will occur on additional days during the summer months.

Continued from previous page...

Non-standard timings. Where the premises will be used for the supply of alcohol at different times from those listed in the column on the left, list below

For example (but not exclusively), where you wish the activity to go on longer on a particular day e.g. Christmas Eve.

State the name and details of the individual whom you wish to specify on the licence as premises supervisor

Name

First name

Family name

Date of birth / /
dd mm yyyy

Enter the contact's address

Building number or name

Street

District

City or town

County or administrative area

Postcode

Country

Personal Licence number (if known)

Issuing licensing authority (if known)

PROPOSED DESIGNATED PREMISES SUPERVISOR CONSENT

How will the consent form of the proposed designated premises supervisor be supplied to the authority?

- Electronically, by the proposed designated premises supervisor
- As an attachment to this application

Reference number for consent form (if known)

If the consent form is already submitted, ask the proposed designated premises supervisor for its 'system reference' or 'your reference'.

Continued from previous page...

Section 16 of 21

ADULT ENTERTAINMENT

Highlight any adult entertainment or services, activities, or other entertainment or matters ancillary to the use of the premises that may give rise to concern in respect of children

Give information about anything intended to occur at the premises or ancillary to the use of the premises which may give rise to concern in respect of children, regardless of whether you intend children to have access to the premises, for example (but not exclusively) nudity or semi-nudity, films for restricted age groups etc gambling machines etc.

N/A

Section 17 of 21

HOURS PREMISES ARE OPEN TO THE PUBLIC

Standard Days And Timings

MONDAY

Start

End

Start

End

Give timings in 24 hour clock.
(e.g., 16:00) and only give details for the days
of the week when you intend the premises
to be used for the activity.

TUESDAY

Start

End

Start

End

WEDNESDAY

Start

End

Start

End

THURSDAY

Start

End

Start

End

FRIDAY

Start

End

Start

End

SATURDAY

Start

End

Start

End

SUNDAY

Start

End

Start

End

State any seasonal variations

Continued from previous page...

For example (but not exclusively) where the activity will occur on additional days during the summer months.

Non standard timings. Where you intend to use the premises to be open to the members and guests at different times from those listed in the column on the left, list below

For example (but not exclusively), where you wish the activity to go on longer on a particular day e.g. Christmas Eve.

Section 18 of 21

LICENSING OBJECTIVES

Describe the steps you intend to take to promote the four licensing objectives:

a) General – all four licensing objectives (b,c,d,e)

List here steps you will take to promote all four licensing objectives together.

SEE ATTACHED

b) The prevention of crime and disorder

SEE ATTACHED

c) Public safety

SEE ATTACHED

d) The prevention of public nuisance

SEE ATTACHED

e) The protection of children from harm

SEE ATTACHED

Application for a new premises licence

Convenience Store, 132 Spotbrough Road, Doncaster DN5 8BA

Operating schedule/proposed licence conditions

This is a new business venture and the site, currently empty, is to become a new general store selling a range of goods including soft drinks, cigarettes, dairy goods, snacks, confectionery, etc.

The applicant, an experienced retailer and a personal licence holder, would like to offer some alcohol sales to allow the business to offer an all-round convenience service to customers.

A detailed and robust operating schedule is proposed to promote the licensing objectives;

Prevention of crime and disorder

A CCTV camera system capable of providing good quality images in all lighting conditions shall be used. Cameras shall cover inside the shop and the area immediately outside. Images will be retained for a period of at least 28 days and be made available to Police Officers, and other authorised persons, on reasonable written request for evidential purposes, in accordance with the relevant data protection legislation (currently GDPR 2018).

The CCTV recording equipment shall be kept in a secure environment under the control of the premises licence holder (PLH) and/or another named responsible individual.

A staff training scheme shall be used for all staff authorised to sell alcohol. The training will cover the importance of preventing under age sales and complying with licence conditions. Refresher training will be provided every 12 months, records will be kept and be made available to responsible authorities

The PLH and staff will be vigilant and monitor the area immediately outside the shop to check that youths are not causing annoyance by congregating.

Spirits will be kept behind the counter.

Any incidents of crime and disorder at or immediately outside the premises, witnessed by staff, will be recorded in an incident book kept at the premises. This book will be kept in the shop and available for inspection.

The premises shall operate an alcohol refusals policy - alcohol will not be sold to;

(1) Any person recognised or identified as a street drinker (regardless of their level of inebriation at the time);

(2) Any person found to be drinking alcohol in the street;

(3) Any person who is drunk or appears to be drunk;

(4) Any person suspected of trying to buy alcohol for another person who is drunk or appears to be drunk;

(5) Any person unable to provide valid ID when requested by staff;

(6) Any person who is verbally or physically abusive towards staff or customers.

(7) To any person suspected of trying to buy alcohol for another person(s) who may be under age.

A notice advising customers of the refusals policy shall be on display.

Public safety

No specific risks have been identified – the PLH shall comply with other legislative requirements to ensure that the shop is safe for customers and staff.

Prevention of public nuisance

Deliveries to the premises will be arranged so as not to cause will not lead to any public nuisance.

Notice(s) shall be on display in the premises asking customers to leave the premises quietly and not to congregate outside the shop.

Staff will monitor the area immediately outside the premises on a regular basis to check for, and to properly dispose of, any litter from the premises.

Protection of children from harm

The shop shall operate a Challenge 25 Policy.

Anyone who appears to be under 25 years old who attempts to purchase alcohol will be asked to prove their age by producing an acceptable form of photographic ID such as a passport, photo driving licence, military ID and PASS accredited proof of age cards.

A refusals register (for the sale of alcohol) will be kept and be available for inspection by responsible authorities.

A notice shall be displayed in the premises where it can be seen clearly to advise customers that it is unlawful for persons under 18 to purchase alcohol or for any persons to purchase alcohol on behalf of a person under 18 years of age.

NOTE TO RESPONSIBLE AUTHORITIES AND OTHER PERSONS - IF YOU HAVE ANY QUERIES OR COMMENTS ON THESE PROPOSALS, PLEASE CONTACT IAN RUSHTON ON [REDACTED] OR BY EMAIL [REDACTED] TO DISCUSS FURTHER - PRIOR TO MAKING ANY REPRESENTATIONS.

Section 19 of 21

NOTES ON DEMONSTRATING ENTITLEMENT TO WORK IN THE UK

Entitlement to work/immigration status for individual applicants and applications from partnerships which are not limited liability partnerships:

A licence may not be held by an individual or an individual in a partnership who is resident in the UK who:

- does not have the right to live and work in the UK; or
- is subject to a condition preventing him or her from doing work relating to the carrying on of a licensable activity.

Any premises licence issued in respect of an application made on or after 6 April 2017 will become invalid if the holder ceases to be entitled to work in the UK.

Applicants must demonstrate that they have an entitlement to work in the UK and are not subject to a condition preventing them from doing work relating to the carrying on of a licensable activity. They do this in one of two ways: 1) by providing with this application copies or scanned copies of the documents listed below (which do not need to be certified), or 2) by providing their 'share code' to enable the licensing authority to carry out a check using the Home Office online right to work checking service (see below).

Documents which demonstrate entitlement to work in the UK

- An expired or current passport showing the holder, or a person named in the passport as the child of the holder, is a British citizen or a citizen of the UK and Colonies having the right of abode in the UK [please see note below about which sections of the passport to copy].
- An expired or current passport or national identity card showing the holder, or a person named in the passport as the child of the holder, is a national of a European Economic Area country or Switzerland.
- A Registration Certificate or document certifying permanent residence issued by the Home Office to a national of a European Economic Area country or Switzerland.
- A Permanent Residence Card issued by the Home Office to the family member of a national of a European Economic Area country or Switzerland.
- A **current** Biometric Immigration Document (Biometric Residence Permit) issued by the Home Office to the holder indicating that the person named is allowed to stay indefinitely in the UK, or has no time limit on their stay in the UK.
- A **current** passport endorsed to show that the holder is exempt from immigration control, is allowed to stay indefinitely in the UK, has the right of abode in the UK, or has no time limit on their stay in the UK.
- A **current** Immigration Status Document issued by the Home Office to the holder with an endorsement indicating that the named person is allowed to stay indefinitely in the UK or has no time limit on their stay in the UK, **when produced in combination with** an official document giving the person's permanent National Insurance number and their name issued by a Government agency or a previous employer.
- A birth or adoption certificate issued in the UK, **when produced in combination with** an official document giving the person's permanent National Insurance number and their name issued by a Government agency or a previous employer.
- A birth or adoption certificate issued in the Channel Islands, the Isle of Man or Ireland **when produced in combination with** an official document giving the person's permanent National Insurance number and their name issued by a Government agency or a previous employer.
- A certificate of registration or naturalisation as a British citizen, **when produced in combination with** an official document giving the person's permanent National Insurance number and their name issued by a Government agency or a previous employer.

Continued from previous page...

- A **current** passport endorsed to show that the holder is allowed to stay in the UK and is currently allowed to work and is not subject to a condition preventing the holder from doing work relating to the carrying on of a licensable activity.
- A **current** Biometric Immigration Document (Biometric Residence Permit) issued by the Home Office to the holder which indicates that the named person can currently stay in the UK and is allowed to work relation to the carrying on of a licensable activity.
- A **current** Residence Card issued by the Home Office to a person who is not a national of a European Economic Area state or Switzerland but who is a family member of such a national or who has derivative rights or residence.
- A **current** Immigration Status Document containing a photograph issued by the Home Office to the holder with an endorsement indicating that the named person may stay in the UK, and is allowed to work and is not subject to a condition preventing the holder from doing work relating to the carrying on of a licensable activity **when produced in combination with** an official document giving the person's permanent National Insurance number and their name issued by a Government agency or a previous employer.
- A Certificate of Application, **less than 6 months old**, issued by the Home Office under regulation 18(3) or 20(2) of the Immigration (European Economic Area) Regulations 2016, to a person who is not a national of a European Economic Area state or Switzerland but who is a family member of such a national or who has derivative rights of residence.
- Reasonable evidence that the person has an outstanding application to vary their permission to be in the UK with the Home Office such as the Home Office acknowledgement letter or proof of postage evidence, or reasonable evidence that the person has an appeal or administrative review pending on an immigration decision, such as an appeal or administrative review reference number.
- Reasonable evidence that a person who is not a national of a European Economic Area state or Switzerland but who is a family member of such a national or who has derivative rights of residence in exercising treaty rights in the UK including:-
 - evidence of the applicant's own identity – such as a passport,
 - evidence of their relationship with the European Economic Area family member – e.g. a marriage certificate, civil partnership certificate or birth certificate, and
 - evidence that the European Economic Area national has a right of permanent residence in the UK or is one of the following if they have been in the UK for more than 3 months:
 - (i) working e.g. employment contract, wage slips, letter from the employer,
 - (ii) self-employed e.g. contracts, invoices, or audited accounts with a bank,
 - (iii) studying e.g. letter from the school, college or university and evidence of sufficient funds; or
 - (iv) self-sufficient e.g. bank statements.

Family members of European Economic Area nationals who are studying or financially independent must also provide evidence that the European Economic Area national and any family members hold comprehensive sickness insurance in the UK. This can include a private medical insurance policy, an EHIC card or an S1, S2 or S3 form.

Original documents must not be sent to licensing authorities. If the document copied is a passport, a copy of the following pages should be provided:-

- (i) any page containing the holder's personal details including nationality;
- (ii) any page containing the holder's photograph;
- (iii) any page containing the holder's signature;
- (iv) any page containing the date of expiry; and
- (v) any page containing information indicating the holder has permission to enter or remain in the UK and is permitted to work.

Continued from previous page...

If the document is not a passport, a copy of the whole document should be provided.

Your right to work will be checked as part of your licensing application and this could involve us checking your immigration status with the Home Office. We may otherwise share information with the Home Office. Your licence application will not be determined until you have complied with this guidance.

Home Office online right to work checking service

As an alternative to providing a copy of the documents listed above, applicants may demonstrate their right to work by allowing the licensing authority to carry out a check with the Home Office online right to work checking service.

To demonstrate their right to work via the Home Office online right to work checking service, applicants should include in this application their 9-digit share code (provided to them upon accessing the service at <https://www.gov.uk/prove-right-to-work>) which, along with the applicant's date of birth (provided within this application), will allow the licensing authority to carry out the check.

In order to establish the applicant's right to work, the check will need to indicate that the applicant is allowed to work in the United Kingdom and is not subject to a condition preventing them from doing work relating to the carrying on of a licensable activity.

An online check will not be possible in all circumstances because not all applicants will have an immigration status that can be checked online. The Home Office online right to work checking service sets out what information and/or documentation applicants will need in order to access the service. Applicants who are unable to obtain a share code from the service should submit copy documents as set out above.

Section 20 of 21

NOTES ON REGULATED ENTERTAINMENT

Continued from previous page...

In terms of specific **regulated entertainments** please note that:

- Plays: no licence is required for performances between 08:00 and 23.00 on any day, provided that the audience does not exceed 500.
- Films: no licence is required for 'not-for-profit' film exhibition held in community premises between 08.00 and 23.00 on any day provided that the audience does not exceed 500 and the organiser (a) gets consent to the screening from a person who is responsible for the premises; and (b) ensures that each such screening abides by age classification ratings.
- Indoor sporting events: no licence is required for performances between 08.00 and 23.00 on any day, provided that the audience does not exceed 1000.
- Boxing or Wrestling Entertainment: no licence is required for a contest, exhibition or display of Greco-Roman wrestling, or freestyle wrestling between 08.00 and 23.00 on any day, provided that the audience does not exceed 1000. Combined fighting sports – defined as a contest, exhibition or display which combines boxing or wrestling with one or more martial arts – are licensable as a boxing or wrestling entertainment rather than an indoor sporting event.
- Live music: no licence permission is required for:
 - o a performance of unamplified live music between 08.00 and 23.00 on any day, on any premises.
 - o a performance of amplified live music between 08.00 and 23.00 on any day on premises authorised to sell alcohol for consumption on those premises, provided that the audience does not exceed 500.
 - o a performance of amplified live music between 08.00 and 23.00 on any day, in a workplace that is not licensed to sell alcohol on those premises, provided that the audience does not exceed 500.
 - o a performance of amplified live music between 08.00 and 23.00 on any day, in a church hall, village hall, community hall, or other similar community premises, that is not licensed by a premises licence to sell alcohol, provided that (a) the audience does not exceed 500, and (b) the organiser gets consent for the performance from a person who is responsible for the premises.
 - o a performance of amplified live music between 08.00 and 23.00 on any day, at the non-residential premises of (i) a local authority, or (ii) a school, or (iii) a hospital, provided that (a) the audience does not exceed 500, and (b) the organiser gets consent for the performance on the relevant premises from: (i) the local authority concerned, or (ii) the school or (iii) the health care provider for the hospital.
- Recorded Music: no licence permission is required for:
 - o any playing of recorded music between 08.00 and 23.00 on any day on premises authorised to sell alcohol for consumption on those premises, provided that the audience does not exceed 500.
 - o any playing of recorded music between 08.00 and 23.00 on any day, in a church hall, village hall, community hall, or other similar community premises, that is not licensed by a premises licence to sell alcohol, provided that (a) the audience does not exceed 500, and (b) the organiser gets consent for the performance from a person who is responsible for the premises.
 - o any playing of recorded music between 08.00 and 23.00 on any day, at the non-residential premises of (i) a local authority, or (ii) a school, or (iii) a hospital, provided that (a) the audience does not exceed 500, and (b) the organiser gets consent for the performance on the relevant premises from: (i) the local authority concerned, or (ii) the school proprietor or (iii) the health care provider for the hospital.

Continued from previous page...

- Dance: no licence is required for performances between 08.00 and 23.00 on any day, provided that the audience does not exceed 500. However, a performance which amounts to adult entertainment remains licensable.
- Cross activity exemptions: no licence is required between 08.00 and 23.00 on any day, with no limit on audience size for:
 - o any entertainment taking place on the premises of the local authority where the entertainment is provided by or on behalf of the local authority;
 - o any entertainment taking place on the hospital premises of the health care provider where the entertainment is provided by or on behalf of the health care provider;
 - o any entertainment taking place on the premises of the school where the entertainment is provided by or on behalf of the school proprietor; and
 - o any entertainment (excluding films and a boxing or wrestling entertainment) taking place at a travelling circus, provided that (a) it takes place within a moveable structure that accommodates the audience, and (b) that the travelling circus has not been located on the same site for more than 28 consecutive days.

Section 21 of 21

PAYMENT DETAILS

This fee must be paid to the authority. If you complete the application online, you must pay it by debit or credit card.

Premises Licence Fees are determined by the non-domestic rateable value of the premises.

To find out a premises non domestic rateable value go to the Valuation Office Agency site at http://www.voa.gov.uk/business_rates/index.htm

Band A - No RV to £4300 £100.00

Band B - £4301 to £33000 £190.00

Band C - £33001 to £87000 £315.00

Band D - £87001 to £125000 £450.00*

Band E - £125001 and over £635.00*

*If the premises rateable value is in Bands D or E and the premises is primarily used for the consumption of alcohol on the premises then you are required to pay a higher fee

Band D - £87001 to £125000 £900.00

Band E - £125001 and over £1,905.00

There is an exemption from the payment of fees in relation to the provision of regulated entertainment at church halls, chapel halls or premises of a similar nature, village halls, parish or community halls, or other premises of a similar nature. The costs associated with these licences will be met by central Government. If, however, the licence also authorises the use of the premises for the supply of alcohol or the provision of late night refreshment, a fee will be required.

Schools and sixth form colleges are exempt from the fees associated with the authorisation of regulated entertainment where the entertainment is provided by and at the school or college and for the purposes of the school or college.

If you operate a large event you are subject to ADDITIONAL fees based upon the number in attendance at any one time

Capacity 5000-9999 £1,000.00

Capacity 10000 -14999 £2,000.00

Capacity 15000-19999 £4,000.00

Capacity 20000-29999 £8,000.00

Capacity 30000-39999 £16,000.00

Capacity 40000-49999 £24,000.00

Capacity 50000-59999 £32,000.00

Capacity 60000-69999 £40,000.00

Capacity 70000-79999 £48,000.00

Capacity 80000-89999 £56,000.00

Capacity 90000 and over £64,000.00

* Fee amount (£)

100.00

DECLARATION

Continued from previous page...

Applicable to individual applicants only, including those in a partnership which is not a limited liability partnership] I understand I am not entitled to be issued with a licence if I do not have the entitlement to live and work in the UK (or if I am subject to a condition preventing me from doing work relating to the carrying on of a licensable activity) and that my licence will become invalid if I cease to be entitled to live and work in the UK (please read guidance note 15).

The DPS named in this application form is entitled to work in the UK (and is not subject to conditions preventing him or her from doing work relating to a licensable activity) and I have seen a copy of his or her proof of entitlement to work, if appropriate (please see note 15)

I am aware of the advertising requirements (newspaper and on the premises) as detailed in the guidance. With regard to the newspaper advert, you are advised not to advertise until you have received confirmation from the licensing authority that the application includes all the required information.

Ticking this box indicates you have read and understood the above declaration

This section should be completed by the applicant, unless you answered "Yes" to the question "Are you an agent acting on behalf of the applicant?"

* Full name

* Capacity

* Date / /
dd mm yyyy

Once you're finished you need to do the following:

1. Save this form to your computer by clicking file/save as...
 2. Go back to <https://www.gov.uk/apply-for-a-licence/premises-licence/doncaster/apply-1> to upload this file and continue with your application.
- Don't forget to make sure you have all your supporting documentation to hand.

IT IS AN OFFENCE LIABLE TO SUMMARY CONVICTION TO A FINE OF ANY AMOUNT UNDER SECTION 158 OF THE LICENSING ACT 2003, TO MAKE A FALSE STATEMENT IN OR IN CONNECTION WITH THIS APPLICATION

IT IS AN OFFENCE UNDER SECTION 24B OF THE IMMIGRATION ACT 1971 FOR A PERSON TO WORK WHEN THEY KNOW, OR HAVE REASONABLE CAUSE TO BELIEVE, THAT THEY ARE DISQUALIFIED FROM DOING SO BY REASON OF THEIR IMMIGRATION STATUS. THOSE WHO EMPLOY AN ADULT WITHOUT LEAVE OR WHO IS SUBJECT TO CONDITIONS AS TO EMPLOYMENT WILL BE LIABLE TO A CIVIL PENALTY UNDER SECTION 15 OF THE IMMIGRATION, ASYLUM AND NATIONALITY ACT 2006 AND PURSUANT TO SECTION 21 OF THE SAME ACT, WILL BE COMMITTING AN OFFENCE WHERE THEY DO SO IN THE KNOWLEDGE, OR WITH REASONABLE CAUSE TO BELIEVE, THAT THE EMPLOYEE IS DISQUALIFIED

OFFICE USE ONLY

Applicant reference number	<input type="text"/>
Fee paid	<input type="text"/>
Payment provider reference	<input type="text"/>
ELMS Payment Reference	<input type="text"/>
Payment status	<input type="text"/>
Payment authorisation code	<input type="text"/>
Payment authorisation date	<input type="text"/>
Date and time submitted	<input type="text"/>
Approval deadline	<input type="text"/>
Error message	<input type="text"/>
Is Digitally signed	<input type="checkbox"/>

MARCH 2008

132 SPOTBROUGH ROAD
DONCASTER ON5 8BA

KEY

S - SHELVING / DISPLAY

T - TOILET

F - FREEZER

C - COOLER

B+W - BEERS + WINES

■ - LICENCE AREA

X - FIRE EXTINGUISHER

SCALE 1-100

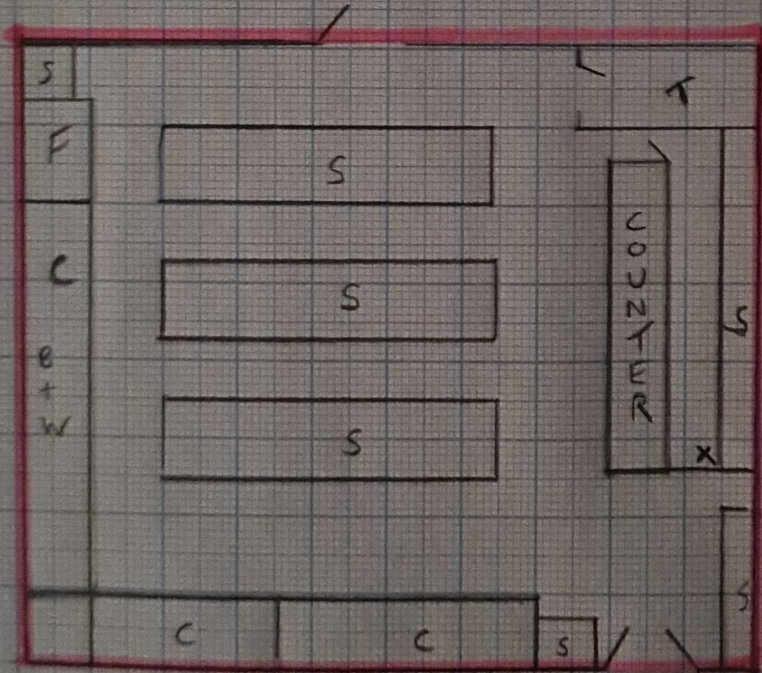

ENTRANCE